

Soils Map

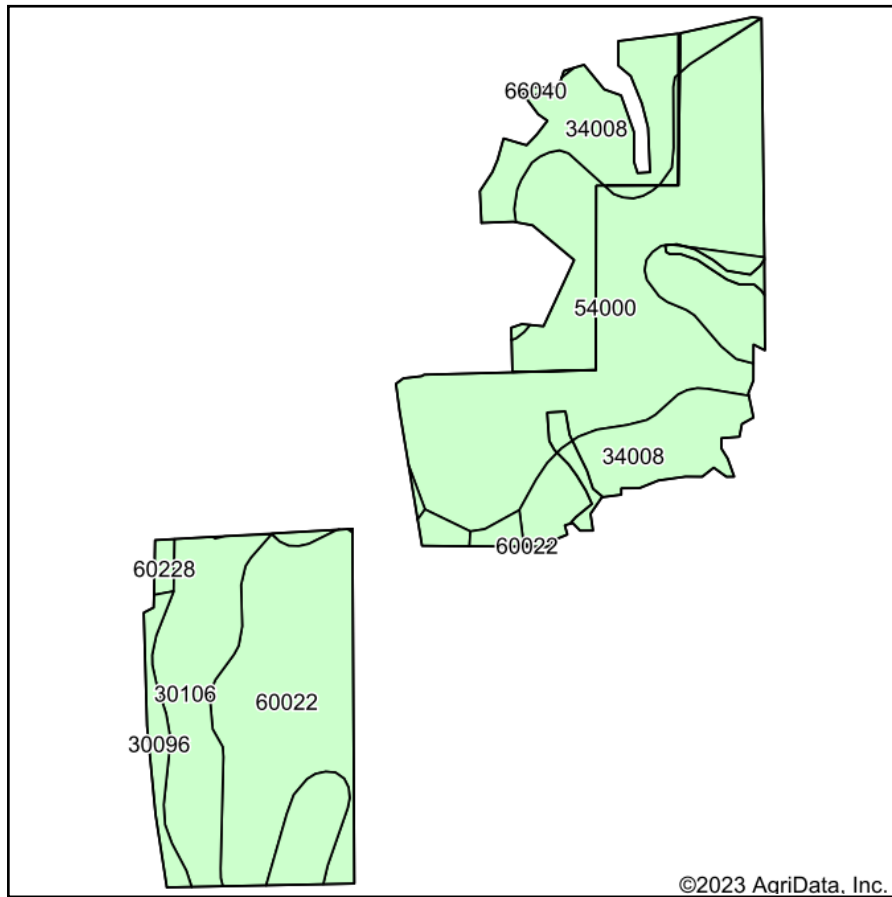

Soils data provided by USDA and NRCS.

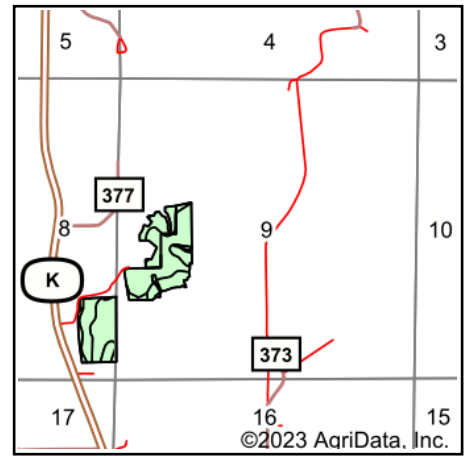

State: **Missouri**
 County: **Lewis**
 Location: **9-62N-9W**
 Township: **Reddish**
 Acres: **46.66**
 Date: **7/31/2023**



Maps Provided By:



Area Symbol: MO111, Soil Area Version: 25

Code	Soil Description	Acres	Percent of field	Non-Irr Class *c	Alfalfa hay Tons	Caucasian bluestem Tons	Common bermudagrass Tons	Orchardgrass red clover Tons	Tall fescue Tons	Warm season grasses Tons
54000	Chariton silt loam, 0 to 2 percent slopes, rarely flooded	18.19	39.0%	IIIw						
34008	Gifford silt loam, 5 to 9 percent slopes, eroded, rarely flooded	10.69	22.9%	IIIe			8	7	8	9
60022	Leonard silt loam, 1 to 6 percent slopes, eroded	9.36	20.1%	IIIe						
30106	Kilwinning silt loam, 1 to 5 percent slopes	6.91	14.8%	IIIe		2	7	6	7	9
30096	Keswick clay loam, Audrain-Shelby plain, 9 to 14 percent slopes, eroded	1.05	2.3%	IVe						
60228	Vanmeter silt loam, 14 to 25 percent slopes	0.46	1.0%	VIe	4	7	4	6	5	7
Weighted Average				3.05	*-	0.4	2.9	2.6	2.9	3.5

*c: Using Capabilities Class Dominant Condition Aggregation Method
 Soils data provided by USDA and NRCS.